

Hydro

UNIVERSAL
BRISE

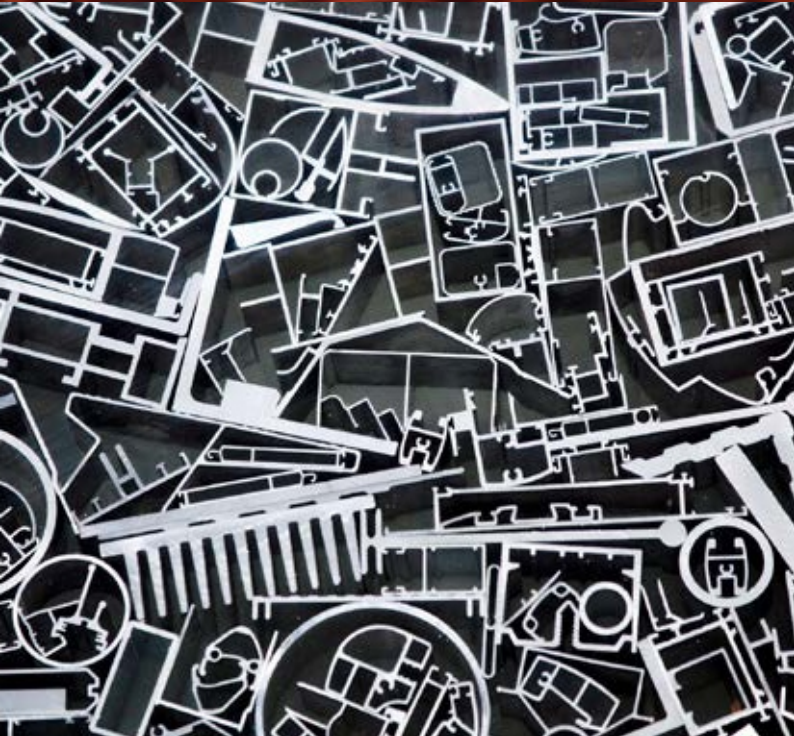



Hydro – A empresa de energia e alumínio

A Hydro é uma líder industrial que constrói negócios e parcerias para um futuro mais sustentável. Desenvolvemos indústrias que fazem a diferença para as pessoas e para a sociedade. Desde 1905, a Hydro transforma recursos naturais em produtos e negócios relevantes para as pessoas, criando um local de trabalho seguro e protegido para nossos 31.000 empregados*, em mais de 140 unidades, em 40 países. Hoje, possuímos e operamos vários negócios, além de investirmos em indústrias sustentáveis.

A Hydro, por meio de seus negócios, está presente em uma ampla gama de segmentos do mercado de alumínio, energia, reciclagem de metais, energias renováveis e baterias, oferecendo conhecimentos e competências únicas.

A Hydro está comprometida em liderar o setor na criação de um futuro mais sustentável, criando sociedades mais viáveis ao desenvolver recursos naturais em produtos e soluções de maneiras inovadoras e eficientes.

*Informação referente a data de fechamento do material.

Hydro Bauxita & Alumina

A Hydro Bauxita & Alumina inclui uma das maiores minas de bauxita do mundo e a maior refinaria de alumina fora da China, ambas no Brasil, representando dois elos importantes na cadeia de produção do nosso alumínio. Nossos mais de 4.000 empregados* trabalham nos escritórios do Brasil, na mina de Paragominas e na refinaria de alumina em Barcarena, no norte do país. Além disso, comercializamos alumina para clientes externos.

Hydro Energia

A Hydro Energia tem mais de 100 anos de experiência em energia hidrelétrica, sendo uma das três maiores operadoras de produção de energia na Noruega e empregando 200 pessoas*. Além disso, estamos envolvidos com energia eólica na Noruega e temos uma participação importante no mercado de energia na região nórdica e no Brasil.



Hydro Extrusão

A Hydro Extrusão é uma empresa líder mundial em extrusão de alumínio, com cerca de 100 unidades de produção, em 40 países, e empregando 20.000 pessoas. Por meio de uma combinação exclusiva de

experiência local, rede global e recursos de P&D incomparáveis, podemos oferecer desde perfis padronizados até desenvolvimento e fabricação avançados para a maioria das indústrias.



Portfólio Hydro

Para todos os tipos e padrões de obras.

<p>Sistemas Comerciais</p>	<p>ECO  FAÇADE</p> <p>UNIT</p> <p>CITTÀ</p> <p>ELEGANCE MIRROR</p> <p>WIND FAÇADE</p>
<p>Sistemas Residenciais</p>	<p>UNICA</p> <p>UNICA MINIMALIST</p> <p>INOVA</p> <p>PRODUTIVA25</p> <p>GOLD Slim</p> <p>NOVA GOLD</p> <p>MASTER</p>
<p>Complementos de Arquitetura</p>	<p>ESPLENDOOR</p> <p>UNIVERSAL VARANDA E GRADIL</p> <p>SKYLINE</p> <p>UNIVERSAL PORTÃO E GRADE</p> <p>UNIVERSAL BRISE</p>



UNIVERSAL

BRISE

Tipologias	B-01 B-03
Perfis	C-01 C-05
Componentes	D-01 D-05
Usinagens	E-01 E-01
Detalhes Construtivos	F-01 F-08
Projetos de Montagem	G-01 G-06

Brise articulado 02 folhas
Sequenciais

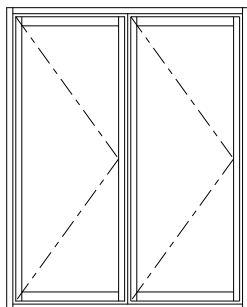

Brise articulado 03 folhas
Sequenciais

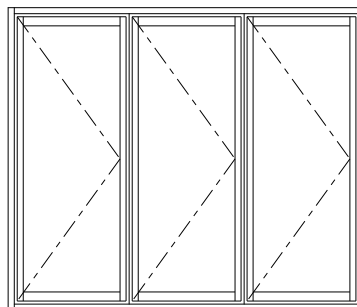

Brise articulado 04 folhas
Sequenciais

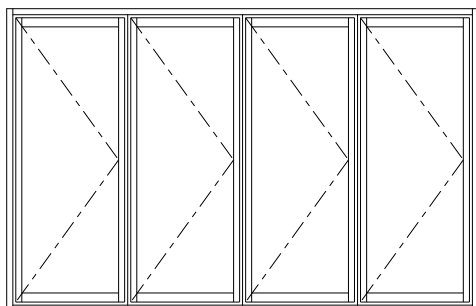

Brise articulado 05 folhas
Sequenciais

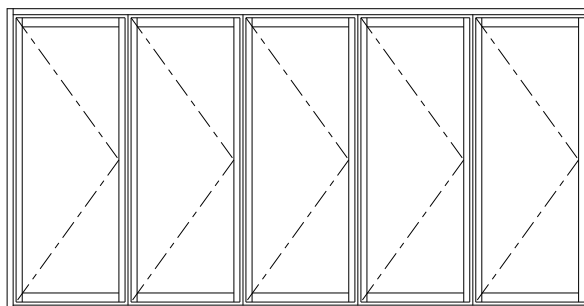

Brise articulado 06 folhas
Sequenciais

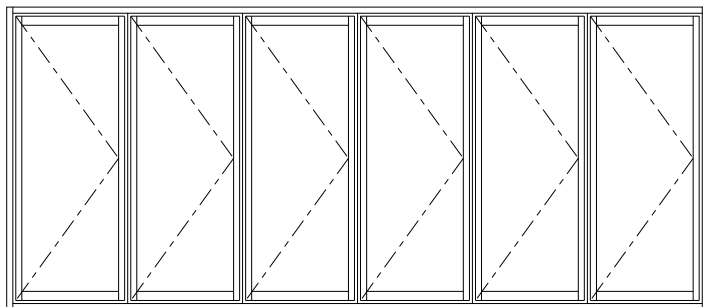

Brise articulado 03 folhas
02 folhas direita e 01 folha esquerda

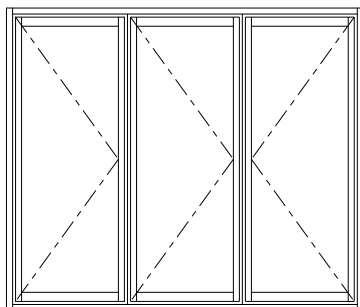

Brise articulado 04 folhas
02 folhas direita e 02 folhas esquerda

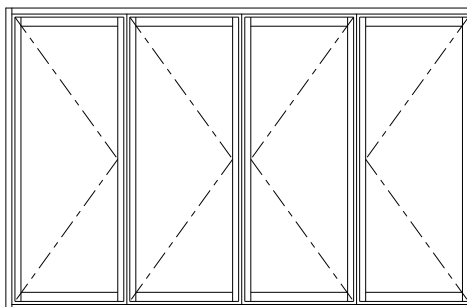

Brise articulado 06 folhas

03 folhas direita e 03 folhas esquerda

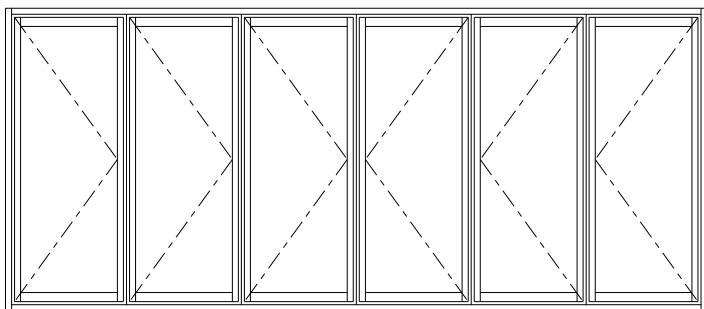

Brise articulado 08 folhas

04 folhas direita e 04 folhas esquerda

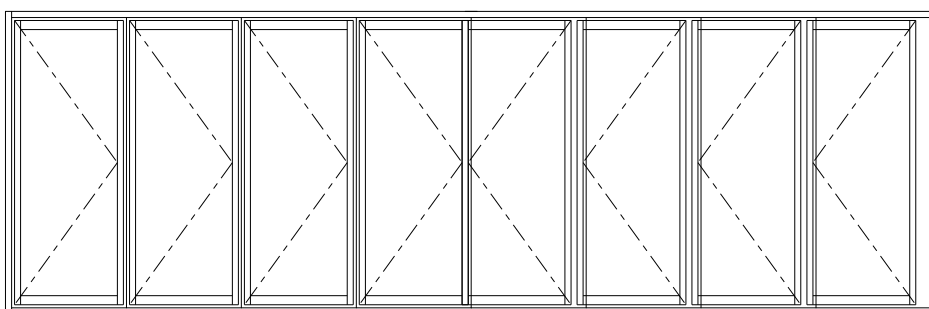

Brise articulado 10 folhas

05 folhas direita e 05 folhas esquerda

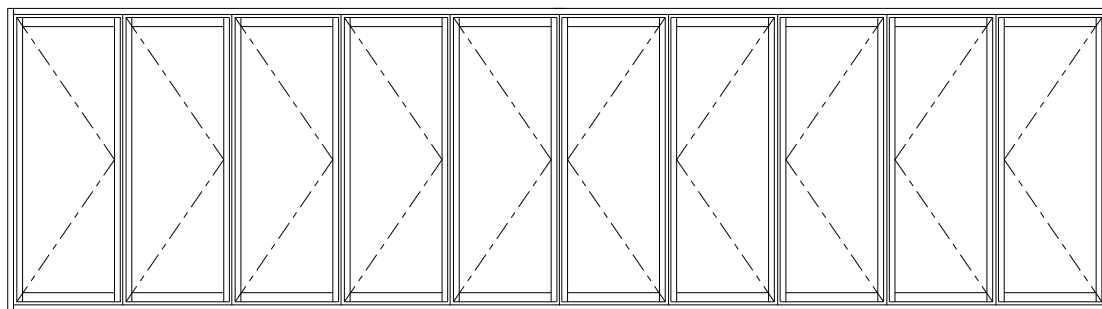

Brise articulado deslizante 04 folhas

02 folhas direita e 02 folhas esquerda

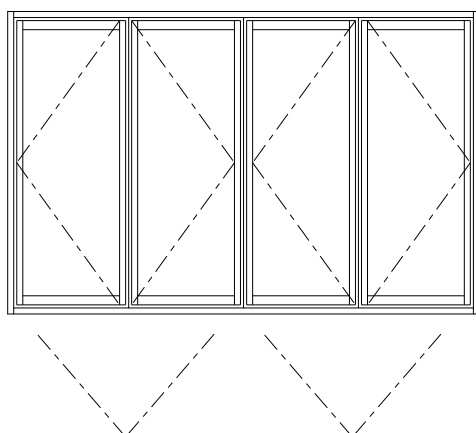

Brise articulado deslizante 06 folhas

02 folhas direita, 02 folhas centrais e 02 folhas esquerda

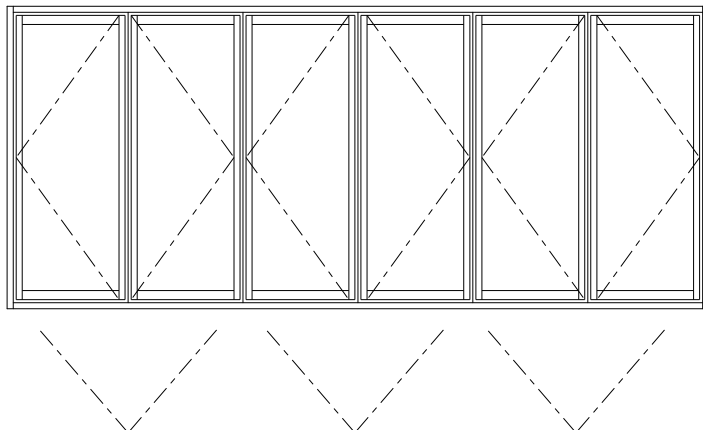

Brise articulado deslizante 08 folhas

02 folhas direita, 04 folhas centrais e 02 folhas esquerda

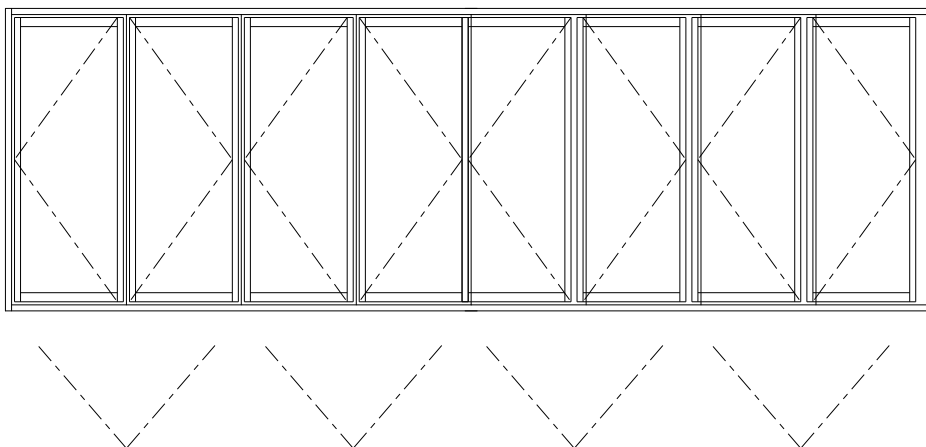

Brise de correr 02 folhas

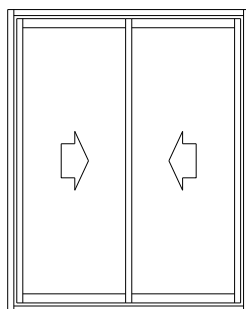

Brise de correr 04 folhas

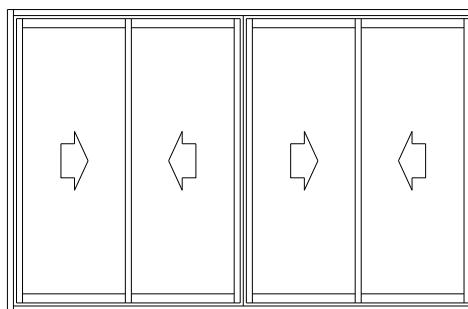

Perfis

Cód.	Pág.
000-558	C-04
CG1042	C-04
CL006	C-03
CL011	C-03
CX8334	C-04
DS023	C-03
FT003	C-04
LB097	C-04
PC032	C-03
RO016	C-03
UB001	C-01
UB002	C-01
UB003	C-01
UB004	C-01
UB005	C-02
UB006	C-02
UB007	C-02
UB008	C-02
UB009	C-02
UB012	C-03
UB013	C-04
UB014	C-04

UB001 1,148 kg/m

Marco superior do trilho

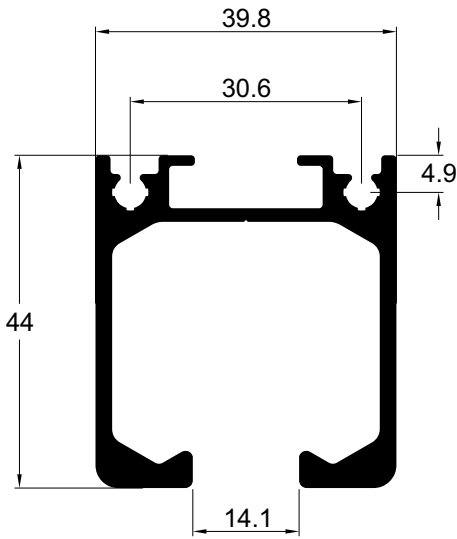

UB002 1,340 kg/m

Marco superior telescópico

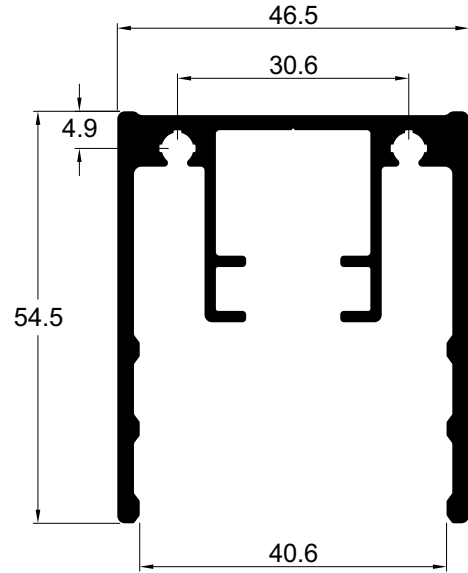

UB003 0,993 kg/m

Montante e travessa da folha

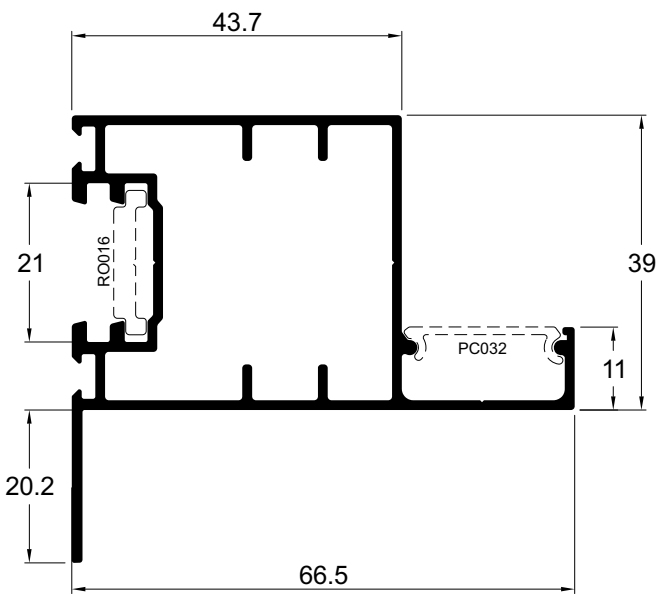

UB004 0,863 kg/m

Montante e travessa da folha

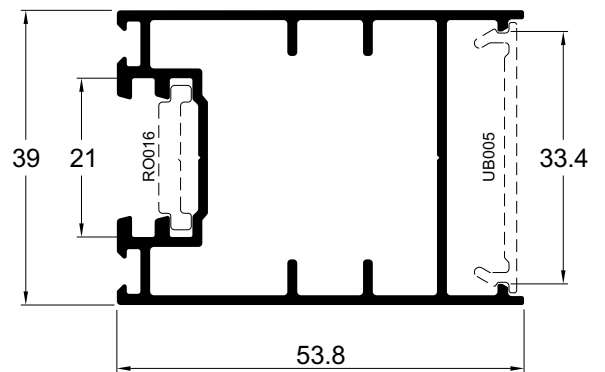

Projetos, perfis, componentes, códigos e sistemas estão sujeitos a alteração sem prévio aviso.

UB005 0,176 kg/m
Tampa para UB004

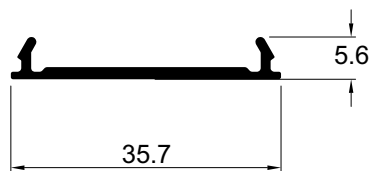

UB006 0,775 kg/m
Marco lateral

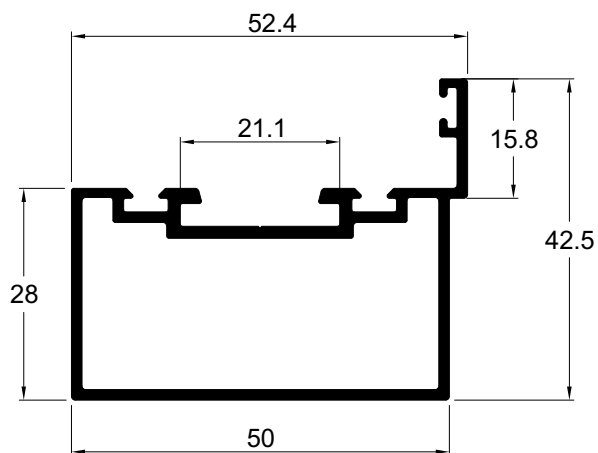

UB007 0,322 kg/m
Trilho inferior embutido

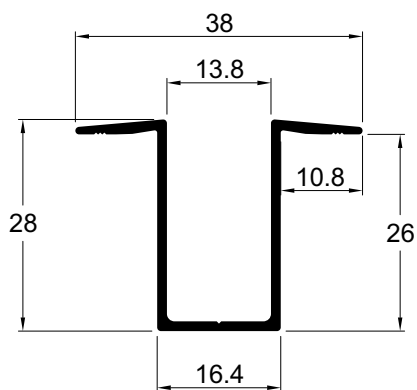

UB008 0,581 kg/m
Trilho inferior

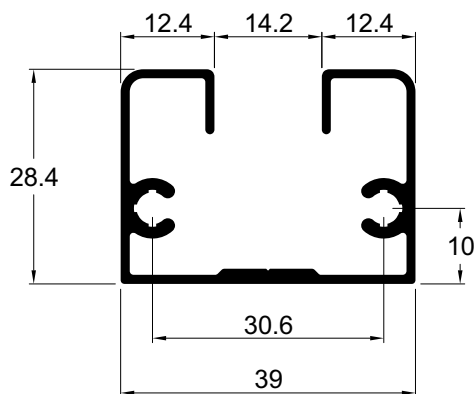

UB009 0,299 kg/m
Lambril

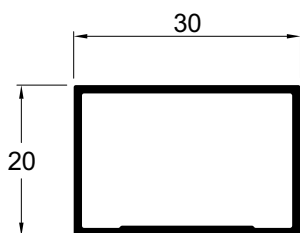

Projetos, perfis, componentes, códigos e sistemas estão sujeitos a alteração sem prévio aviso.

UB012 0,653 kg/m
Travessa intermediária

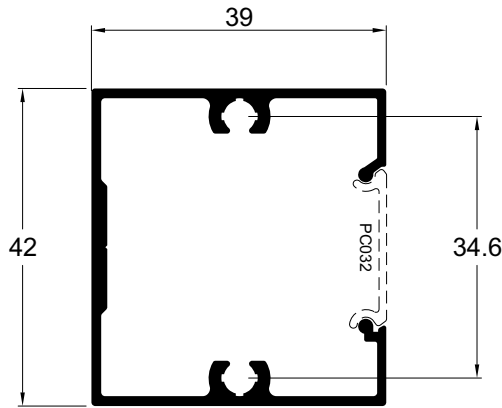

PC032 0,080 kg/m
Tampa

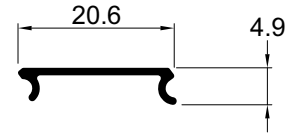

DS023 0,100 kg/m
Complemento do mão de amigo

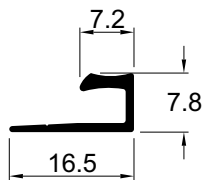

RO016 0,146 kg/m
Barra de comando

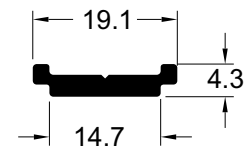

CL006 1,112 Kg/m
Conexão macho

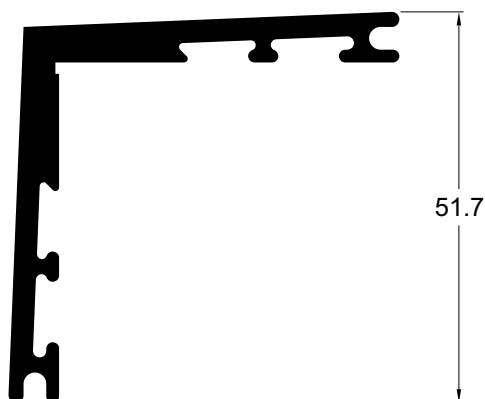

CL011 0,317 Kg/m
Conexão cunha

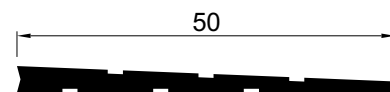

Projetos, perfis, componentes, códigos e sistemas estão sujeitos a alteração sem prévio aviso.

000558 0,293 kg/m
Veneziana aleta

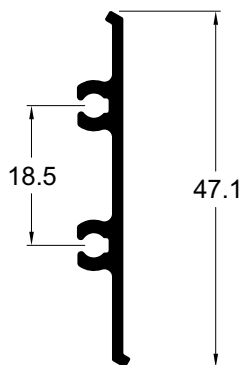

CX8334 0,328 kg/m
Brise

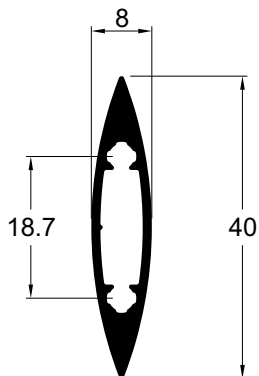

CG1042 0,477 kg/m
Brise

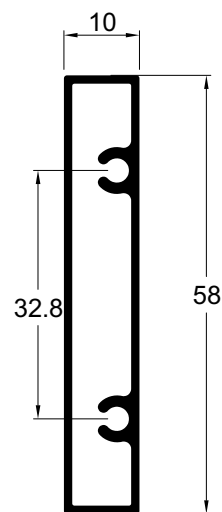

UB013 0,274 kg/m
Travessa para muxarabi

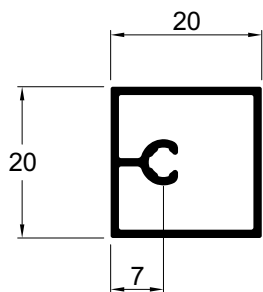

UB014 0,253 kg/m
Coluna para muxarabi

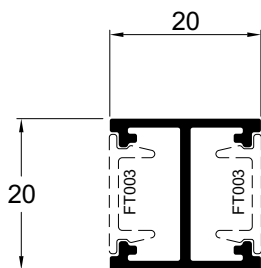

FT003 0,082 kg/m
Tampa

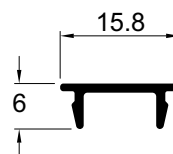

Projetos, perfis, componentes, códigos e sistemas estão sujeitos a alteração sem prévio aviso.

LB097 1,059 kg/m
Lambril ripado

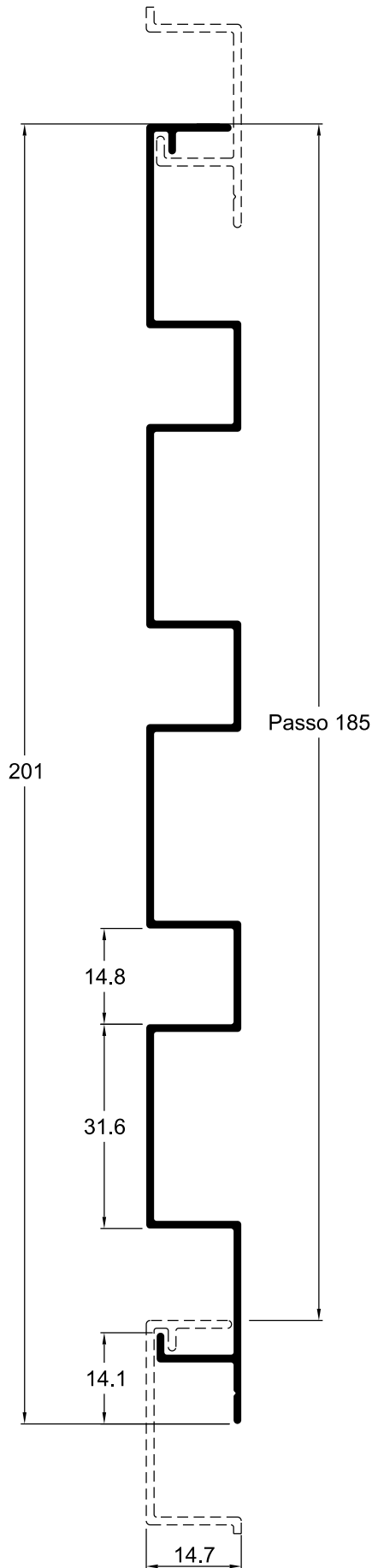

Projetos, perfis, componentes, códigos e sistemas estão sujeitos a alteração sem prévio aviso.

Cód.	Pág.
ARR764	D-05
BAT952	D-03
BUC755	D-05
CHU797	D-05
CON595	D-04
CON597	D-04
CON598	D-04
DOB878	D-02
DOB879	D-02
DOB880	D-02
DOB881	D-02
DOB883	D-02
DOB884	D-02
FEC1282	D-01
FEC1283	D-01
FEC1284	D-01
FIT212	D-05
FIT214	D-05
FRA1004	D-01

Cód.	Pág.
GUA623	D-05
NYL042	D-03
PAR1023	D-05
PAR1031	D-05
PAR1037	D-05
PAR1058	D-05
PAR428	D-05
PAR2033	D-05
PAR2034	D-05
PIV765	D-03
PIV766	D-03
PRE1011	D-04
POR547	D-05
ROL032	D-03
ROL033	D-03
SUP1011	D-03
TRA079	D-03

FEC1282

Cremona de abertura baixa

Alumínio Preto ou Branco

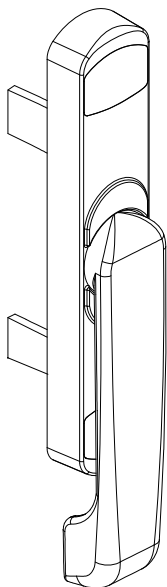

FEC1283

Cremona de abertura alta

Alumínio Preto ou Branco

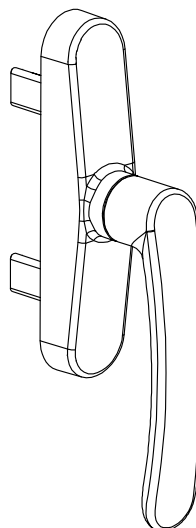

FEC1284

Cremona de abertura alta com chave

Alumínio Preto ou Branco

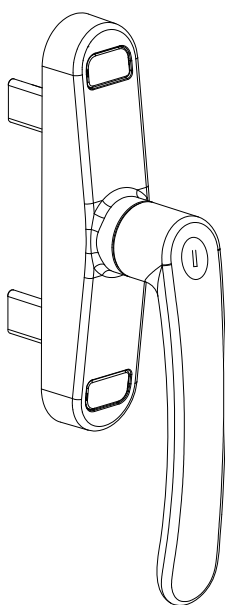

FRA1004

Mecanismo central com parafusos

Alumínio sem acabamento

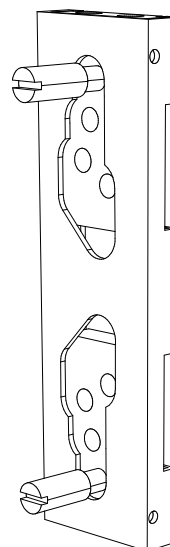

Projetos, perfis, componentes, códigos e sistemas estão sujeitos a alteração sem prévio aviso.

DOB880

Dobradiça aba maior para janela

Alumínio Preto ou Branco

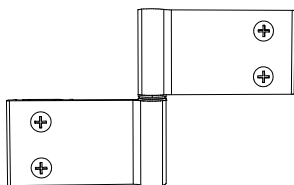

DOB878

Dobradiça aba maior para porta

Alumínio Preto ou Branco

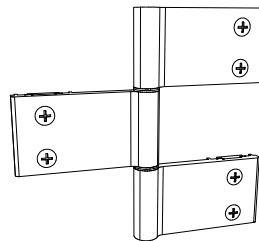

DOB881

Dobradiça aba menor para janela

Alumínio Preto ou Branco

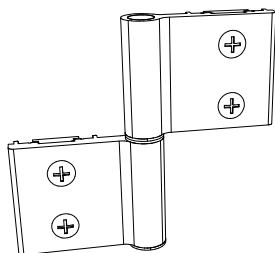

DOB879

Dobradiça aba menor para porta

Alumínio Preto ou Branco

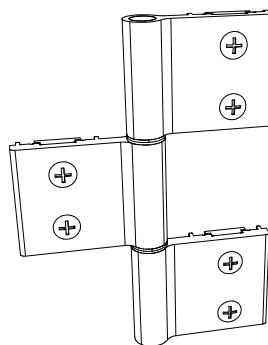

DOB884

Dobradiça aba menor para janela com puxador

Alumínio Preto ou Branco

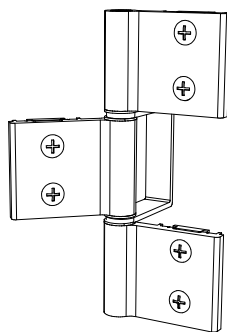

DOB883

Dobradiça aba maior para porta com puxador

Alumínio Preto ou Branco

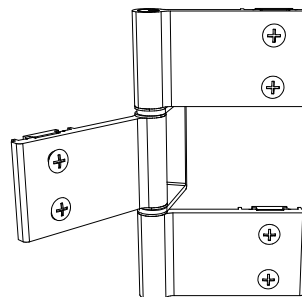

Projetos, perfis, componentes, códigos e sistemas estão sujeitos a alteração sem prévio aviso.

TRA079

Ponteira CE 8 mm

Latão

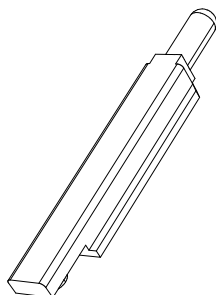

SUP1011

Conjunto de regulagem telescópica do marco

Incluso: Parafusos M6x25 e M8x35

Alumínio, inox

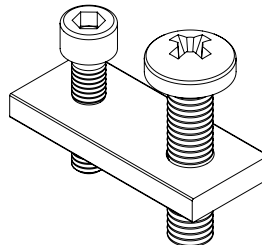

ROL032

Roldana superior da folha

Capacidade: 75kg

Alumínio, nylon

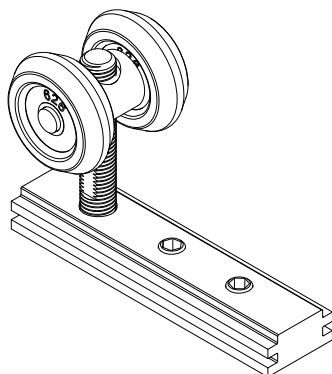

ROL033

Roldana superior dupla da folha

Capacidade: 150kg

Alumínio, nylon

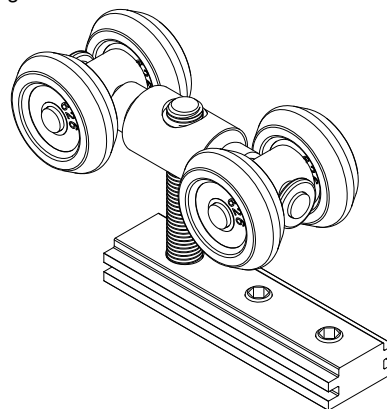

PIV765

Pino guia da folha

Alumínio, nylon

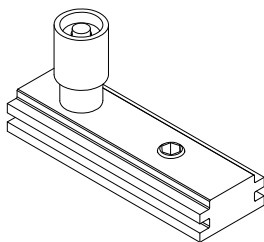

PIV766

Guia CE 12 mm

Alumínio, nylon

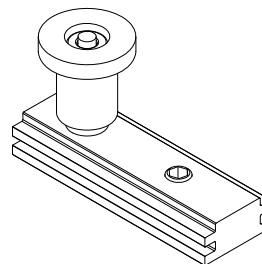

NYL042

Botão Tampa Furo 3/8"

Nylon Branco ou Preto



BAT952

Batedeira da Folha.

Nylon Branco ou Preto.

Aplicação: Janelas de Correr

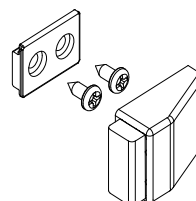

PRE1011

Presilha para fixação do muxarabi

Alumínio sem acabamento

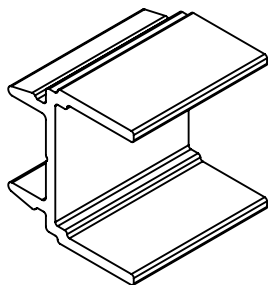

CON597

Conexão de pressão 35 x 8,5

Alumínio sem acabamento

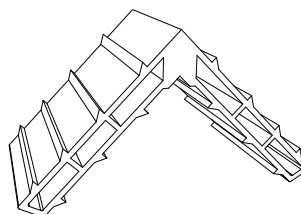

CON598

Conexão hallen 35 x 9,5

Alumínio sem acabamento

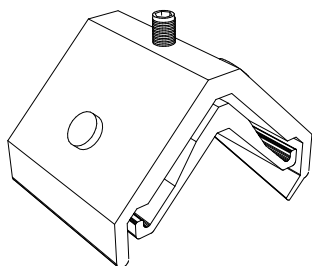

CON595

Conexão expansiva 30 mm

Alumínio sem acabamento

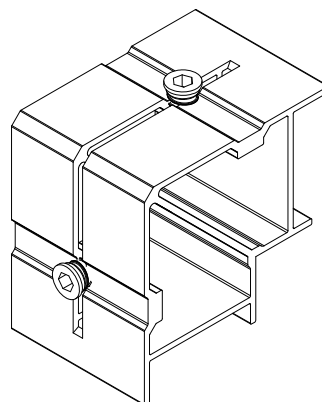

Projetos, perfis, componentes, códigos e sistemas estão sujeitos a alteração sem prévio aviso.

FIT212

Fita Vedadora 5 mm x 8 mm
Preta

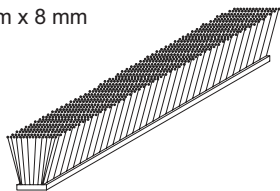

FIT214

Fita Vedadora 5 mm x 10 mm
Preta

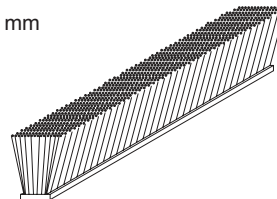

BUC755

Bucha de Nylon S8

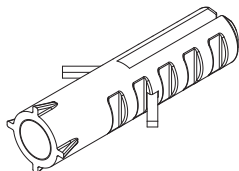

GUA623

Guarnição do mão de amigo
Material: E.P.D.M. Preto

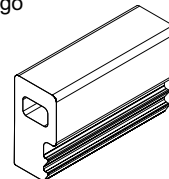

PAR1037

Parafuso auto atarrachante
cabeça panela - fenda philips
4,8 x 50 mm

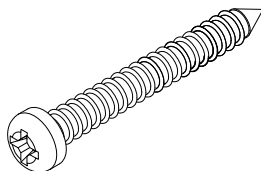

Material: Aço inox 304

CHU797

Chumbador expansivo 1/4" x 82mm
com porca, arruela e prisioneiro

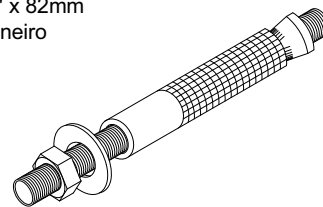

Material: Aço inox 304

PAR2033

Parafuso rosca mecânica
cabeça cilíndrica - fenda philips
M8 x 20 mm

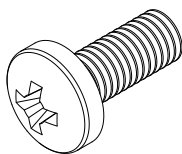

Material: Aço inox 304

PAR2034

Parafuso rosca mecânica
cabeça cilíndrica - fenda philips
M8 x 25 mm

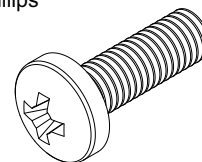

Material: Aço inox 304

POR547

Porca sextavada M8

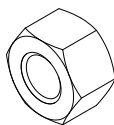

Material: Aço inox 304

ARR764

Arruela de pressão M8



Material: Aço inox 304

PAR1023

Parafuso auto atarrachante
cabeça panela - fenda philips
3,9 x 9,5 mm

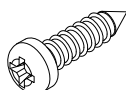

Material: Aço inox 304

PAR1058

Parafuso auto atarrachante
cabeça chata - fenda philips
4,2 x 13 mm

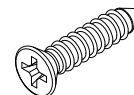

Material: Aço inox 304

PAR1031

Parafuso auto atarrachante
cabeça panela - fenda philips
4,2 x 9,5 mm

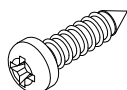

Material: Aço inox 304

PAR428

Parafuso auto atarrachante
cabeça panela ponta piloto - fenda combinada
4,8 x 32 mm

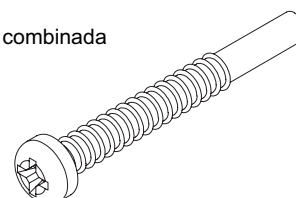

Material: Aço inox 304

Projetos, perfis, componentes, códigos e sistemas estão sujeitos a alteração sem prévio aviso.

Descrição	Pág.
Opções de usinagens do marco lateral UB006	E-01

OPÇÕES DE USINAGENS DO MARCO LATERAL - UB006

Peças conforme e contrário

Instalação frente de laje

Lado superior

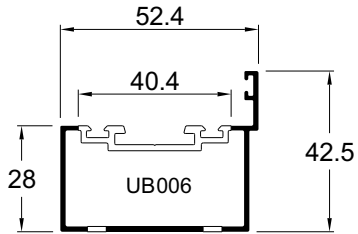

Lado superior

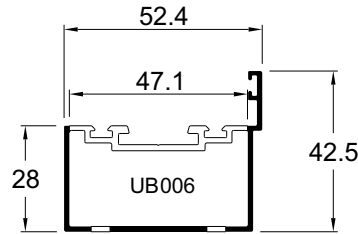

Lado superior

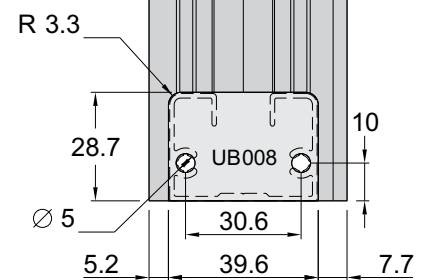
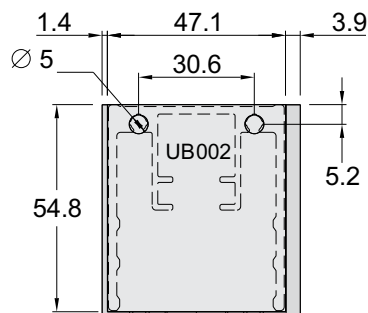
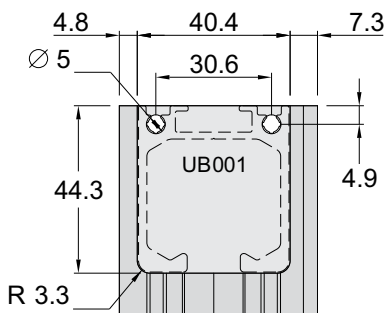
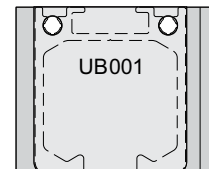

Lado inferior

Lado inferior

Lado inferior

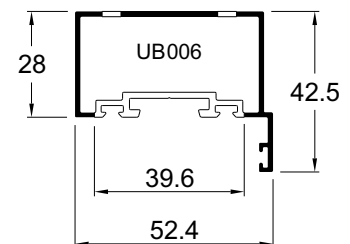

Detalhes Construtivos

Aplicação de roldana simples 75kg (ROL032)

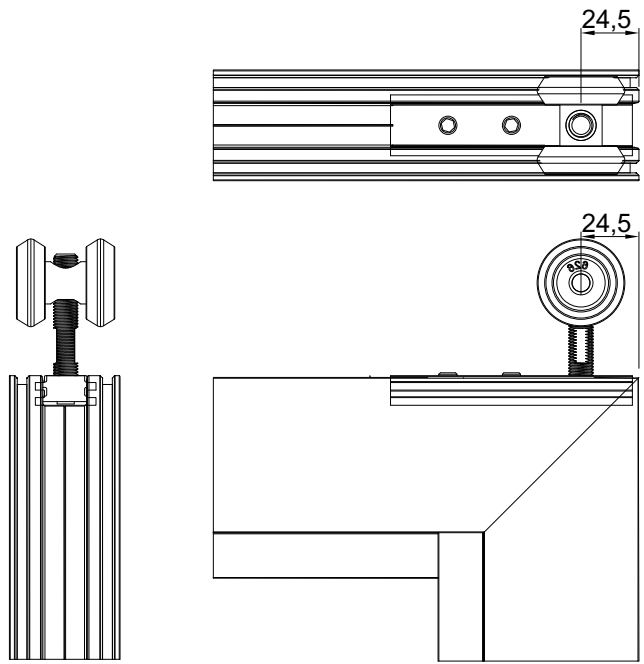

Aplicação das conexões

CL006 E CL011	CON595	CON597 E CON598

Limites das folhas

JANELAS

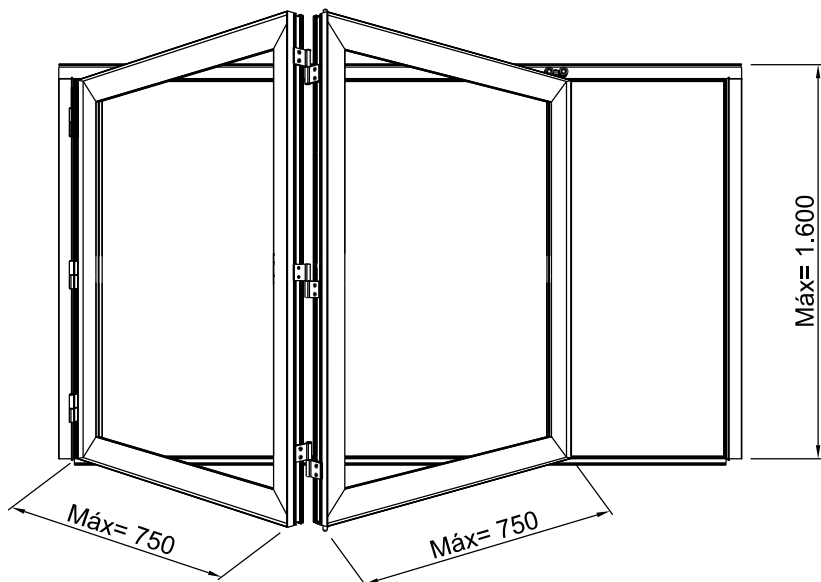

Peso maximo por folha = 75kg.
Acima de 75 kg por folha consultor departamento técnico.

PORTAS

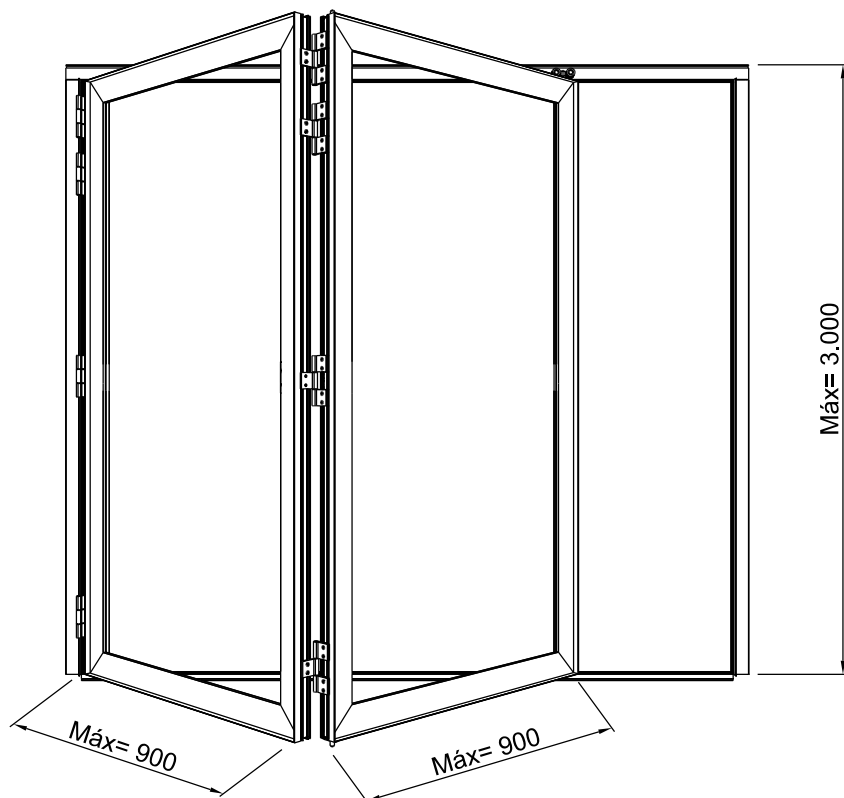

Peso maximo por folha = 75kg.
Acima de 75 kg por folha consultor departamento técnico.

Utilização das dobradiças

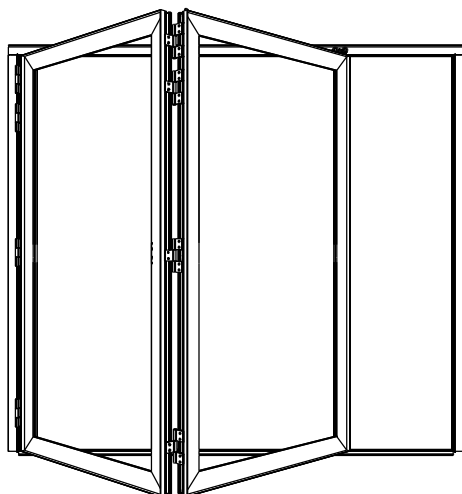

Utilizar 4 dobradiças por folha, como indicado:

- Carga máxima 90kg para dobradiça tripla, 4 unidades;
- Carga máxima de 60 kg para dobradiça dupla, 3 unidades;

Dimensão máxima das folhas:

- Porta - 900 x 3000;
- Janela - 750 x 1600;

Largura mínima das folhas = 450mm

Para medidas acima das recomendadas, consultar a quantidade de dobradiças a utilizar.
Para cargas acima de 90kg, consultar departamento técnico.

JANELA	PORTA
<p>DOB880 Dobradiça de aba maior</p>	<p>DOB878 Dobradiça de aba maior</p>
<p>DOB881 Dobradiça de aba menor</p>	<p>DOB879 Dobradiça de aba menor</p>

Brise articulado 02 folhas Sequencial

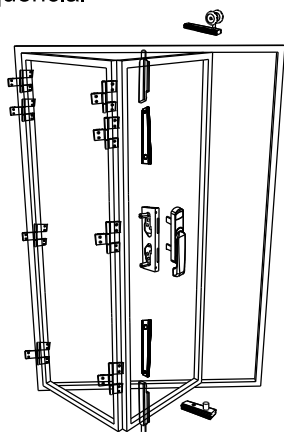

Regra de utilização das dobradiças:

Janela	Porta
DOB880	DOB878
DOB881	DOB879

Com a cremone FEC1282:

- Utilizar a dobradiça DOB880 / DOB878 na parte externa.
- Utilizar a dobradiça DOB881 / DOB879 na parte interna.

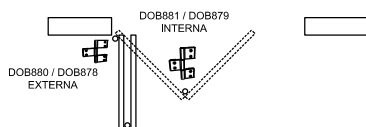
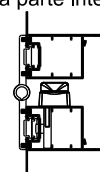
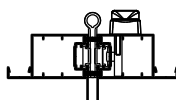

FEC1282
Cremone de abertura
baixa



Brise articulado 02 folhas Sequencial

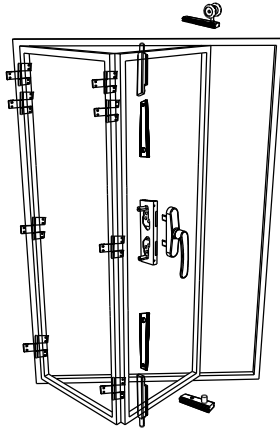

Regra de utilização das dobradiças:

Janela	Porta
DOB880	DOB878
DOB881	DOB879

Com a cremona FEC1283 ou FEC1284:

- Utilizar a dobradiça DOB880 ou DOB878 na parte interna e externa.

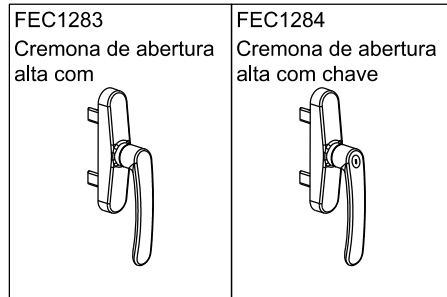
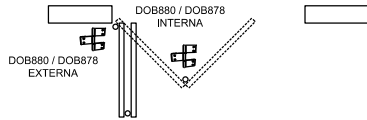
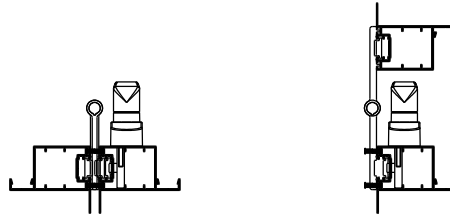

Brise articulado 04 folhas Sequencial

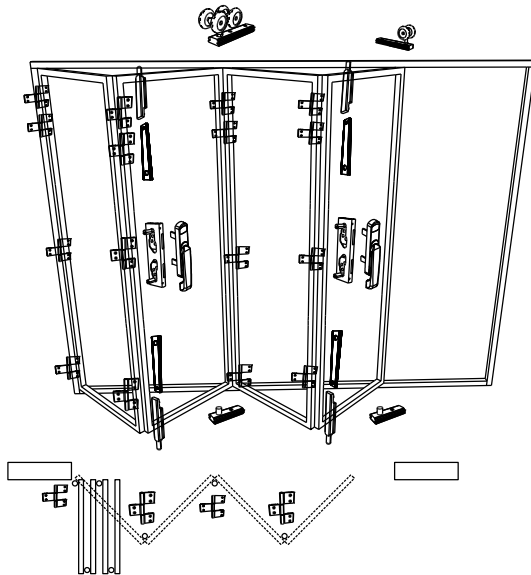

Regra de utilização das roldanas:

- ROL032
- ROL033

- Utilizar a roldana ROL032 na folha de fechamento no marco lateral.
- Utilizar a roldana ROL033 na união de folhas.

Peso máximo por folha = 75kg.



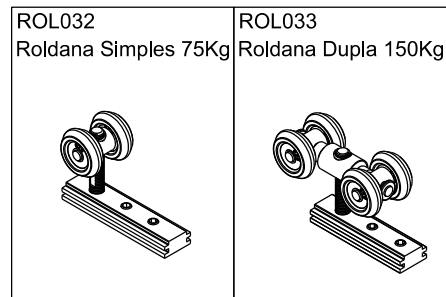



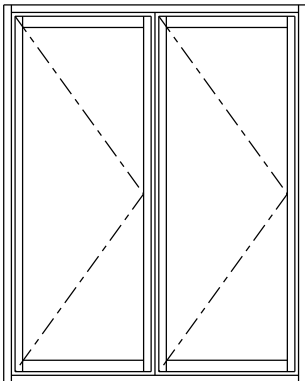

Para pesos acima de 75 kg por folha consultar departamento técnico.

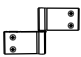

Brise articulado 02 folhas Sequenciais

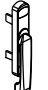
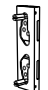



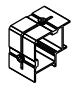



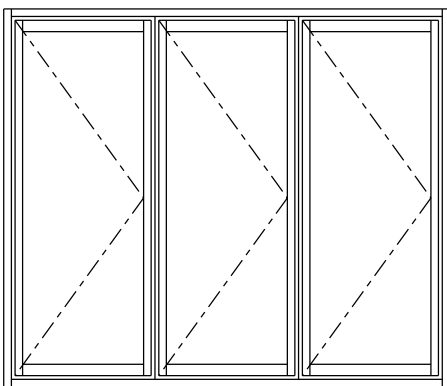

Componentes

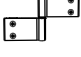
JANELAS DOB880 DOB881   03 pçs 03 pçs		PORTAS DOB878 DOB879   04 pçs 04 pçs		FEC1282  01 pç	FRA1004  01 pç	TRA089  02 pçs	ROL032  01 pç	PIV765  01 pç	CON595  08 pç
---	--	--	--	--	--	--	---	---	---

Brise articulado 03 folhas Sequenciais





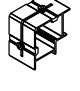



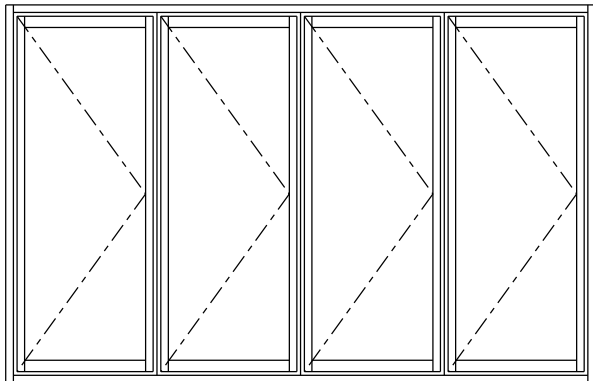

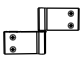

Componentes

JANELAS DOB880 DOB881   06 pçs 03 pçs		PORTAS DOB878 DOB879   08 pçs 04 pçs		FEC1282  02 pçs	FRA1004  02 pçs	TRA089  04 pçs	ROL033  01 pç	PIV765  01 pç	CON595  12 pçs
---	--	--	--	---	---	--	---	---	--

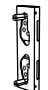
Brise articulado 04 folhas Sequenciais









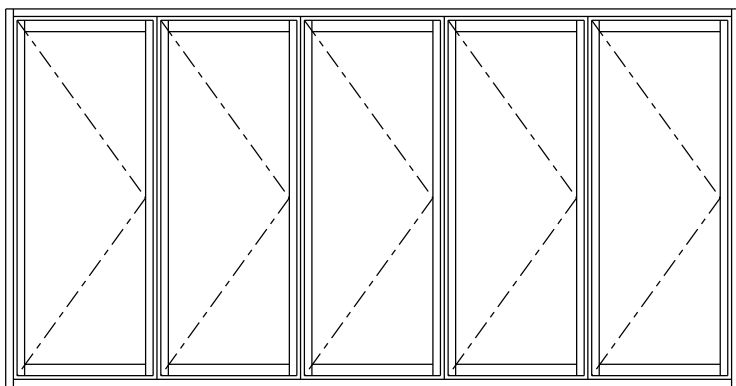

Componentes

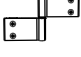
JANELAS DOB880  06 pçs		JANELAS DOB881  06 pçs		PORTAS DOB878  08 pçs		PORTAS DOB879  08 pçs		FEC1282  02 pçs	FRA1004  02 pçs	TRA089  04 pçs	ROL032  01 pç	ROL033  01 pç	PIV765  02 pçs	CON595  16 pç
---	--	---	--	--	--	--	--	---	---	--	---	---	--	---

Brise articulado 05 folhas Sequenciais





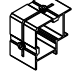



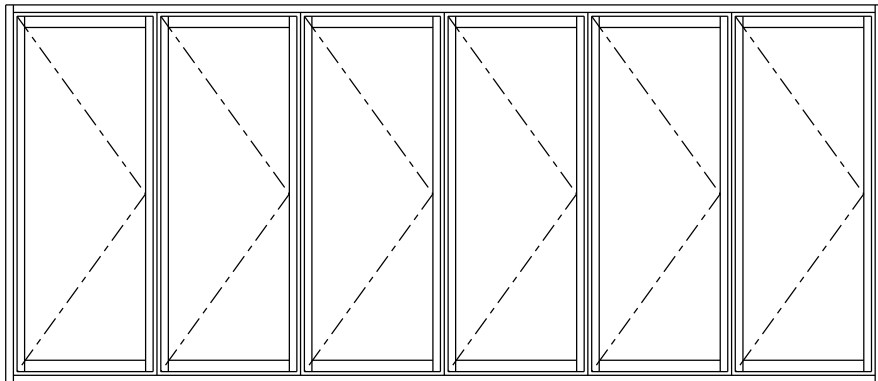

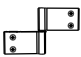

Componentes

JANELAS DOB880  09 pçs		JANELAS DOB881  06 pçs		PORTAS DOB878  12 pçs		PORTAS DOB879  08 pçs		FEC1282  03 pçs	FRA1004  03 pçs	TRA089  06 pçs	ROL033  02 pçs	PIV765  02 pçs	CON595  20 pçs
---	--	---	--	--	--	--	--	---	---	--	--	--	--

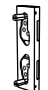
Brise articulado 06 folhas Sequenciais









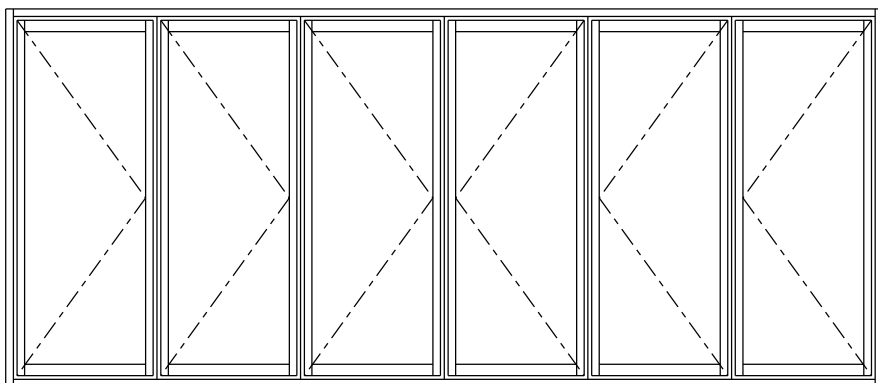

Componentes

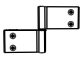
JANELAS DOB880  09 pçs		JANELAS DOB881  09 pçs		PORTAS DOB878  12 pçs		PORTAS DOB879  12 pçs		FEC1282  03 pçs	FRA1004  03 pçs	TRA089  06 pçs	ROL032  01 pç	ROL033  02 pçs	PIV765  03 pçs	CON595  24 pçs
---	--	---	--	--	--	--	--	---	---	--	---	--	--	--

Brise articulado 06 folhas 03 folhas direita e 03 folhas esquerda





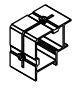



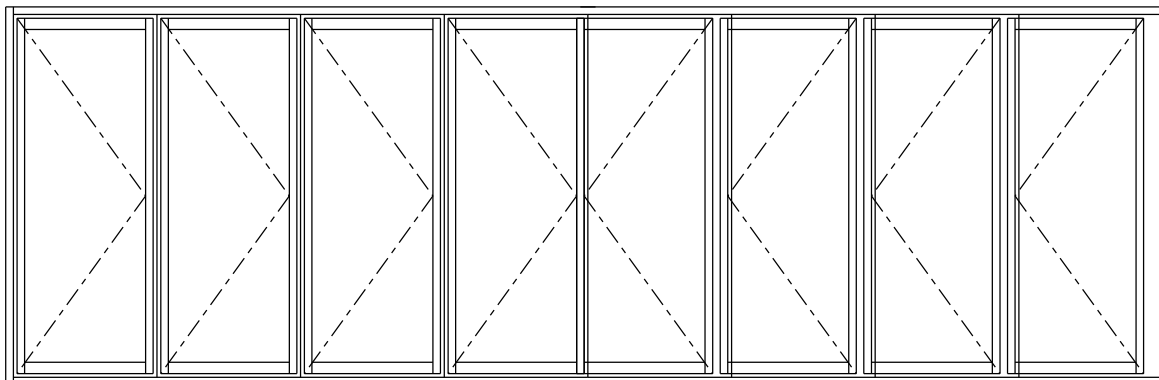

Componentes

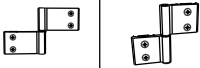
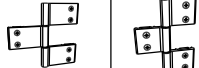
JANELAS DOB880  12 pçs		JANELAS DOB881  06 pçs		PORTAS DOB878  16 pçs		PORTAS DOB879  08 pçs		FEC1282  04 pçs	FRA1004  04 pçs	TRA089  08 pçs	ROL033  02 pçs	PIV765  02 pçs	CON595  24 pçs
---	--	---	--	--	--	--	--	---	---	--	--	--	--

Brise articulado 08 folhas
04 folhas direita e 04 folhas esquerda







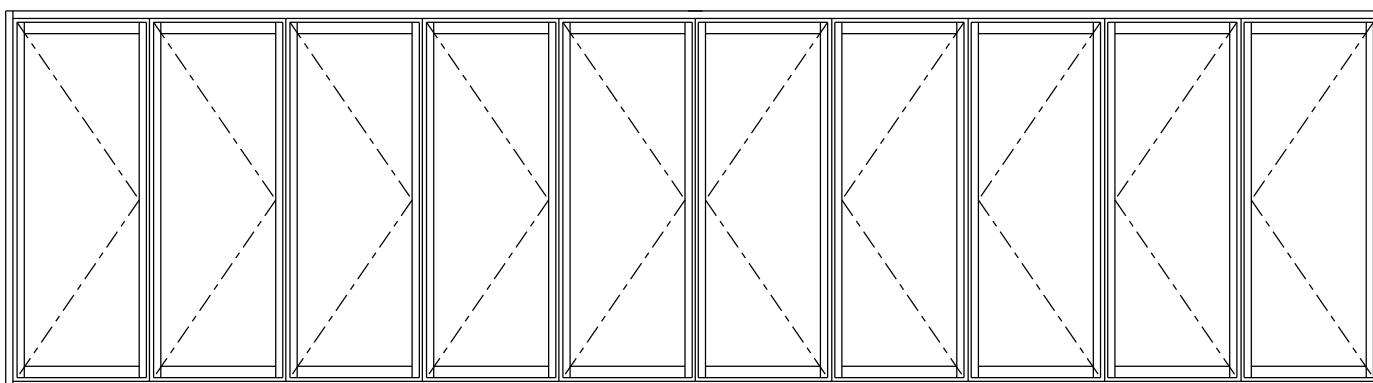

Componentes

<p>JANELAS</p> <p>DOB880 DOB881</p>  <p>12 pçs 12 pçs</p>		<p>PORTAS</p> <p>DOB878 DOB879</p>  <p>16 pçs 16 pçs</p>		<p>FEC1282</p>  <p>04 pçs</p>	<p>FRA1004</p>  <p>04 pçs</p>	<p>TRA089</p>  <p>08 pçs</p>	<p>ROL032</p>  <p>02 pçs</p>	<p>ROL033</p>  <p>02 pçs</p>	<p>PIV765</p>  <p>04 pçs</p>	<p>CON595</p>  <p>32 pçs</p>
---	--	--	--	---	---	--	---	---	---	---

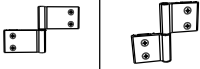
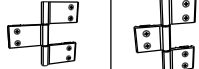
Brise articulado 10 folhas
05 folhas direita e 05 folhas esquerda

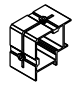

Componentes

<p>JANELAS</p> <p>DOB880 DOB881</p>  <p>18 pçs 12 pçs</p>		<p>PORTAS</p> <p>DOB878 DOB879</p>  <p>24 pçs 16 pçs</p>		<p>FEC1282</p>  <p>06 pçs</p>	<p>FRA1004</p>  <p>06 pçs</p>	<p>TRA089</p>  <p>12 pçs</p>	<p>ROL033</p>  <p>04 pçs</p>	<p>PIV765</p>  <p>04 pçs</p>	<p>CON595</p>  <p>40 pçs</p>
---	--	--	--	--	--	---	---	---	---

Muxarabi

Instruções de montagem

01

Separe os perfis **UB014**, **UB013** e **FT003** já cortados, e as presilhas **PRE1011** e parafusos necessários para a montagem do Muxarabi.

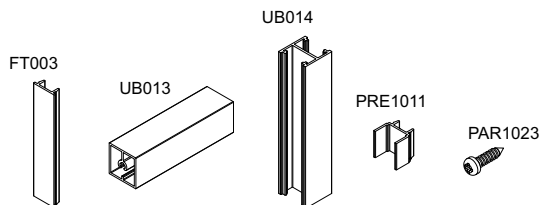
03

Continue encaixando a sequência de presilhas e tampas até completar toda altura da coluna UB014.

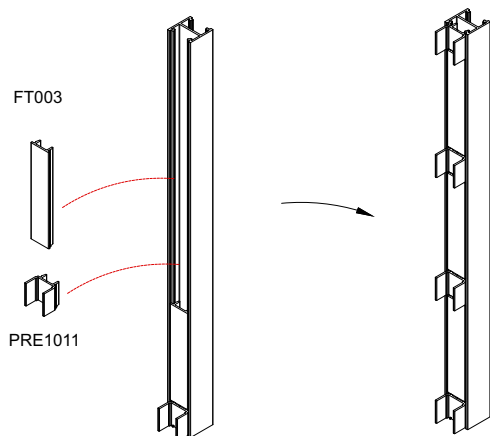
05

Encaixe o primeiro módulo montado na segunda coluna, engavetando com as presilhas PRE1011.

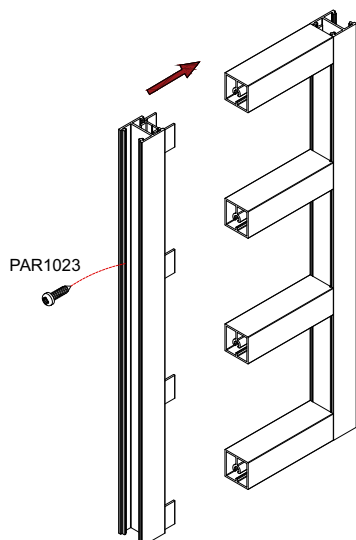

* Defina um espaçamento apropriado de acordo com as dimensões do seu painel para travar em intervalos regulares as travessas com parafusos PAR1023

02

Posicione a primeira barra da coluna UB014 que irá iniciar a sequência do primeiro módulo do painel do Muxarabi e clique a primeira presilha

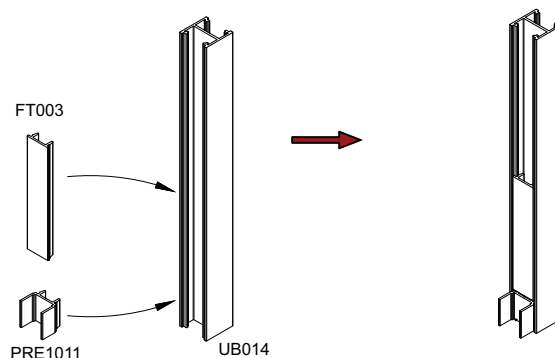
04

Acrescente as travessas UB013 nas presilhas, até completar toda altura da coluna UB014.

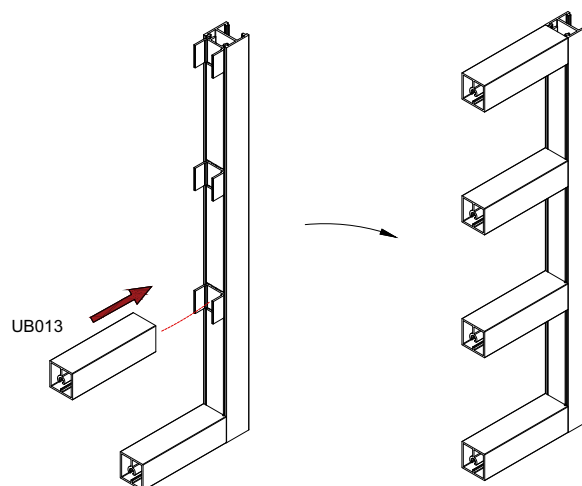

06

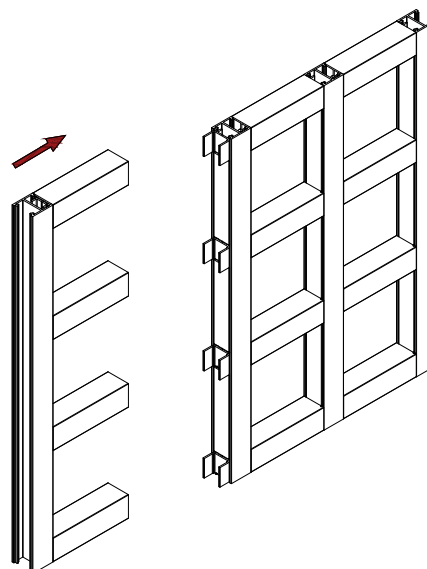
Repita o processo e continue encaixando todos os módulos até finalizar o painel completo do Muxarabi.

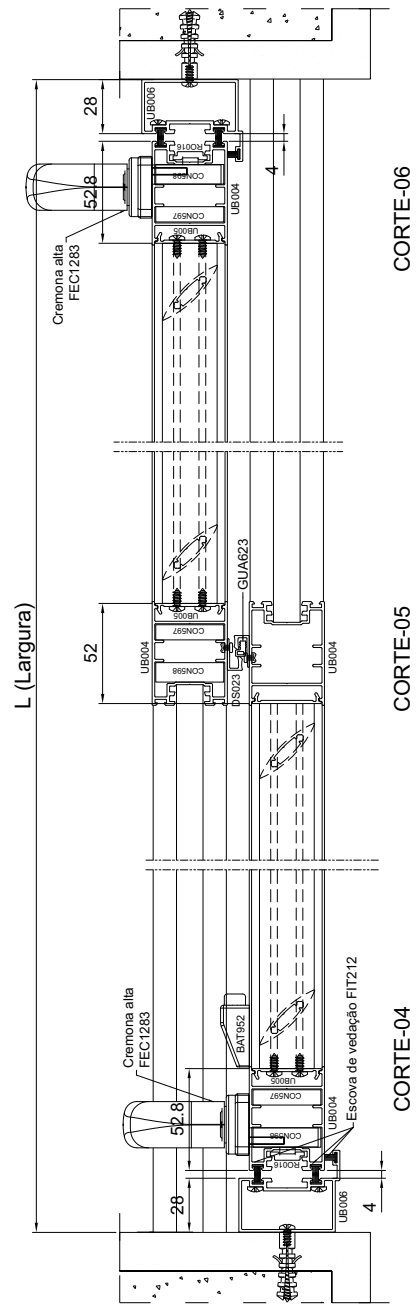
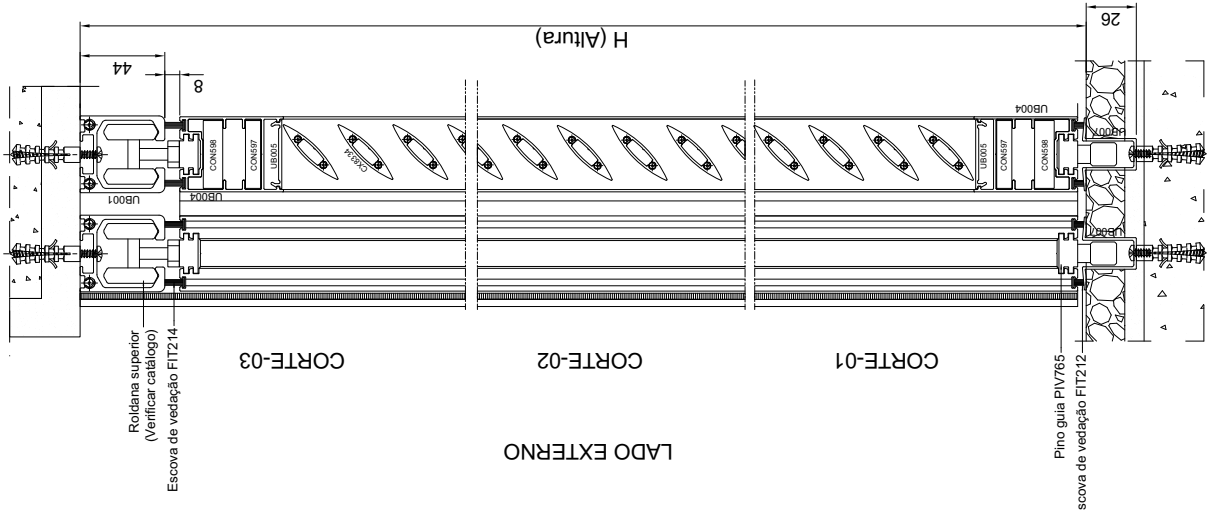
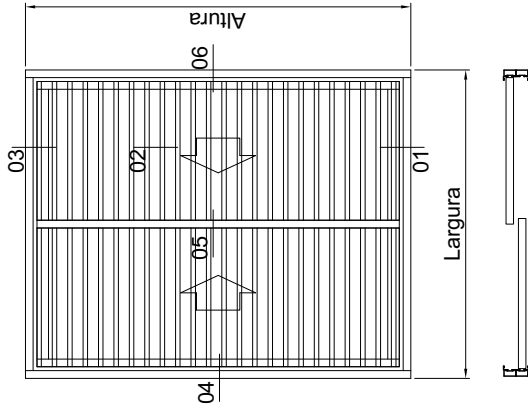

Descrição	Pág.
Brise articulado 02 folhas sequenciais com lambril ripado	G-01
Brise articulado 02 folhas sequenciais com perfil brise	G-02
Brise articulado 04 folhas (02 dir. e 02 esq.) com lambril ripado	G-03
Brise articulado 04 folhas (02 dir. e 02 esq.) com perfil brise	G-04
Brise de correr 02 folhas com perfil brise	G-05

Elevação vista externa



LADO EXTERNO

BRISE DE CORRER 02 FOLHAS COM PERFIL BRISE

UNIVERSAL

BRISE

Catálogo UNIVERSAL BRISE®

Edição 01

www.hydro.com



Hydro